



**20/4 Hindle Terrace Bella Vista NSW**

3 2 2

This well-presented townhouse benefits from all the conveniences of modern living. It is located in a leafy cul-de-sac within stone's throw to Village Green Park, childcare centre, buses to the City, Castle Towers, Westmead and Parramatta.

This residence comes with two stylishly renovated bathrooms and has been recently painted, so you can enjoy your home as soon as you move in, or achieve the optimal rental return as an investor.

Being the largest block in the community, it offers a generous size backyard with manicured gardens and a private gate connecting to Village Green Park walkway. There's also a sparkling swimming pool for the enjoyment

**Type** : Townhouse  
**Price** : Expressions of Interest  
**Land Size** : 196 sqm  
**View** : <https://www.theavenurealestate.com.au/8142659>



**Soha Soheili**  
02 9634 3444



**Sherry Soheili**  
02 9634 3444

[For full version visit the website](#)



SITE PLAN

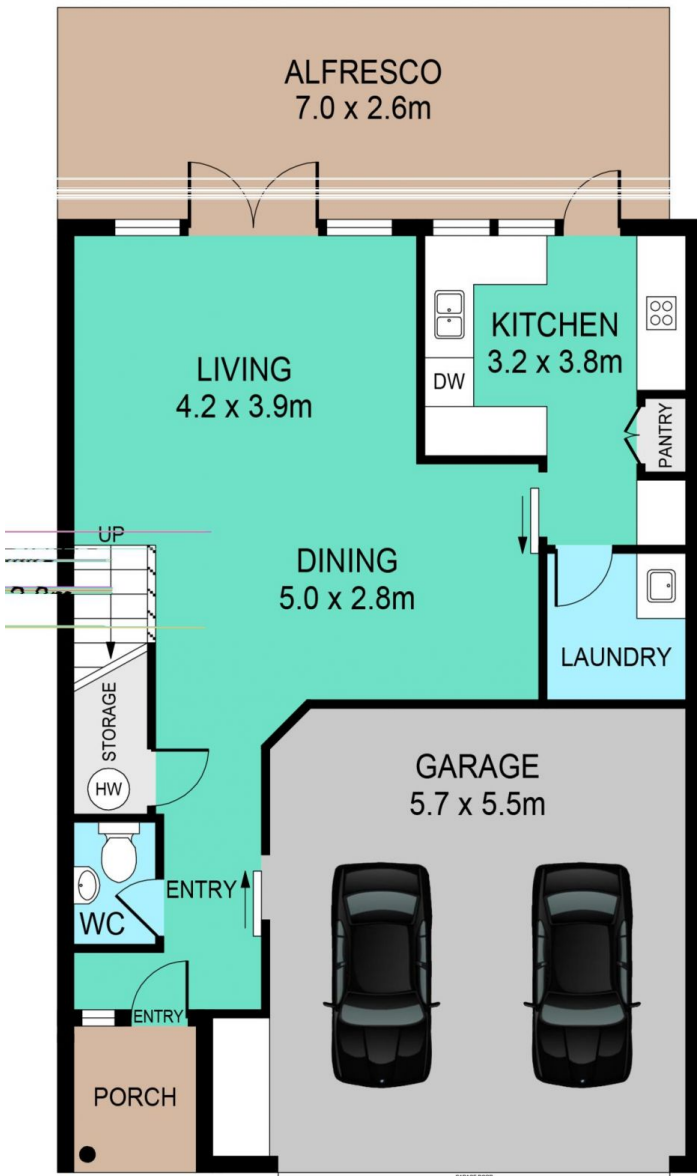

GROUND FLOOR

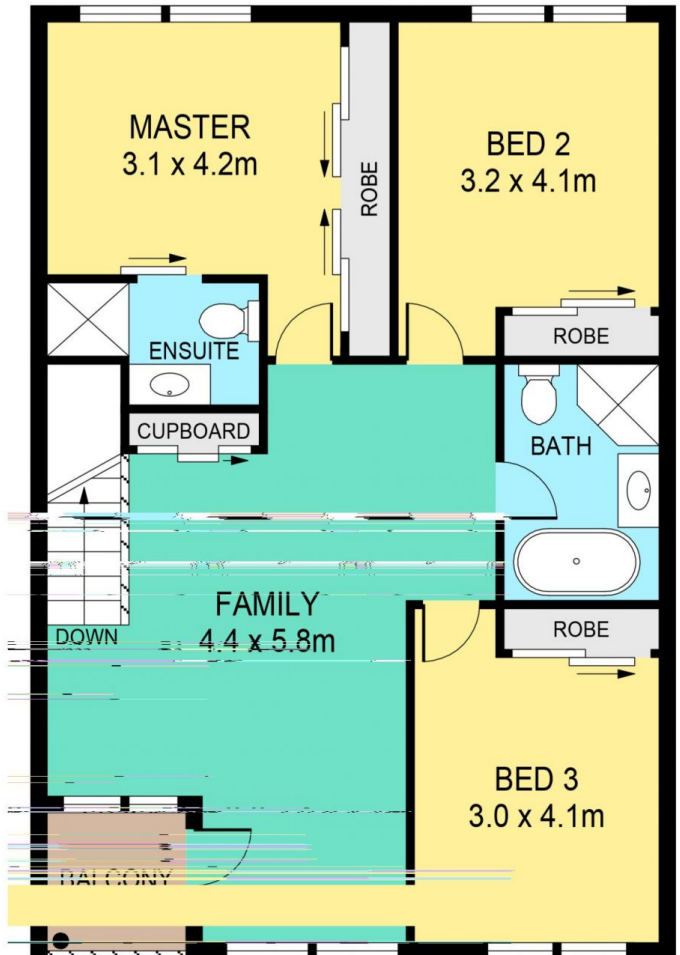

FIRST FLOOR

## 20/4 HINDLE TERRACE, BELLA VISTA

**DISCLAIMER:**

PLANS SHOWN ARE FOR MARKETING PURPOSES ONLY, ALL DIMENSIONS ARE APPROXIMATE AND NOT TO SCALE. THEY ARE SUBJECT TO ERRORS AND INACCURACIES AND NO LIABILITY WILL BE ACCEPTED. INTERESTED PARTIES SHOULD MAKE THEIR OWN INQUIRIES.